

## Exhaust system - exploded view of components

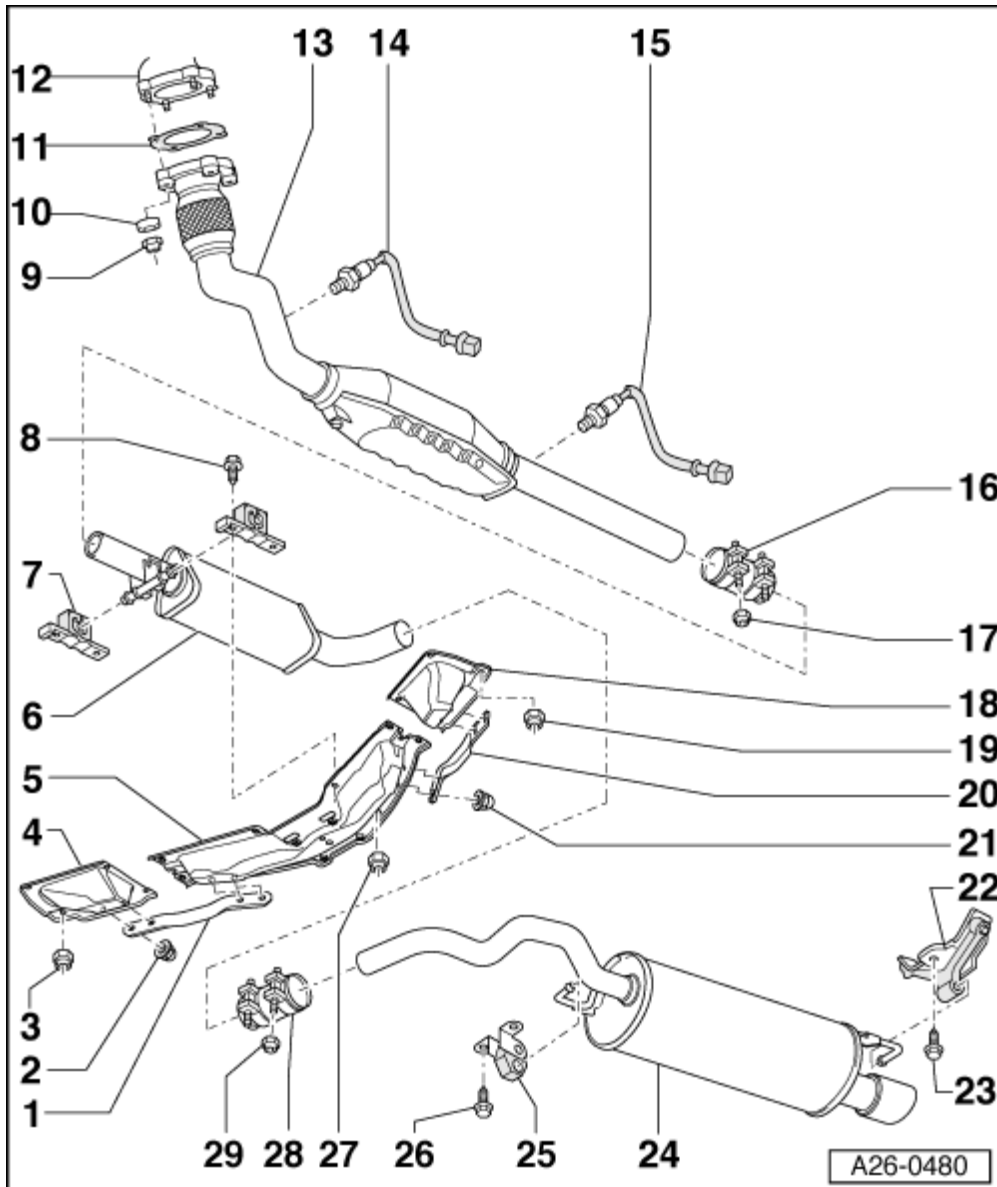

1 - Support

q For TT Roadster

2 - 20 Nm

3 - 20 Nm

4 - Outer cross member

q For TT Roadster

5 - Tunnel cross-piece

q With bore for aligning exhaust system → [Chapter](#)

6 - Centre silencer

q Combined in one unit with rear silencer as original equipment. Can be renewed individually for repair purposes

q Cutting point → [Anchor](#)

q Align exhaust system so it is free of stress → [Chapter](#)

7 - Mounting

- q Renew if damaged
- q Installation position → [Fig.](#)
- 8 - 23 Nm
- 9 - 40 Nm
- q Renew
- 10 - Spacer
- 11 - Gasket
- q Renew
- 12 - Turbocharger
- q Removing and installing → [Chapter](#)
- 13 - Front exhaust pipe with catalytic converter
- q Protect against knocks and impact
- q With flexible joint
- q Do not bend flexible joint more than 10° - otherwise it can be damaged
- q Removing and installing → [Chapter](#)
- q Align exhaust system so it is free of stress → [Chapter](#)
- 14 - Lambda probe -G39- (before catalytic converter)
- q The threads on the new Lambda probes are coated with a special assembly paste.
- q If re-installing old Lambda probe, coat thread with high-temperature paste: Refer to → [Parts catalogue](#) for high-temperature paste.
- q The assembly paste/high-temperature paste must not get into the slots on the probe body.
- q Tighten to 55 Nm
- 15 - Lambda probe after catalytic converter -G130-
- q Not fitted on engine code AJQ
- q The threads on the new Lambda probes are coated with a special assembly paste.
- q If re-installing old Lambda probe, coat thread with high-temperature paste: Refer to → [Parts catalogue](#) for high-temperature paste.
- q The assembly paste/high-temperature paste must not get into the slots on the probe body.
- q Tighten to 55 Nm
- 16 - Clamp (front)
- q Align exhaust system so it is free of stress before tightening clamp → [Chapter](#)
- q Installation position → [Fig.](#)
- q Tighten bolt connections evenly
- 17 - 40 Nm
- 18 - Outer cross member
- q For TT Roadster
- 19 - 20 Nm
- 20 - Support
- q For TT Roadster
- 21 - 20 Nm
- 22 - 20 Nm

## 23 - Mounting

q Renew if damaged

24 - 23 Nm

## 25 - Rear silencer

q Combined in one unit with centre silencer as original equipment. Can be renewed individually for repair purposes

q Cutting point → [Anchor](#)

q Align exhaust system so it is free of stress → [Chapter](#)

## 26 - Mounting

q Renew if damaged

27 - 23 Nm

## 28 - Clamp (rear)

q For separate replacement of centre and rear silencers

q Align exhaust system so it is free of stress before tightening clamp → [Chapter](#)

q Installation position → [Fig.](#)

q Tighten bolt connections evenly

29 - 40 Nm

## Installation position of front clamp

– Position clamp about 5 mm away from marking “A”-arrow 1- and tighten evenly to 40 Nm.



Note

Ignore marking “S”-arrow 2-.

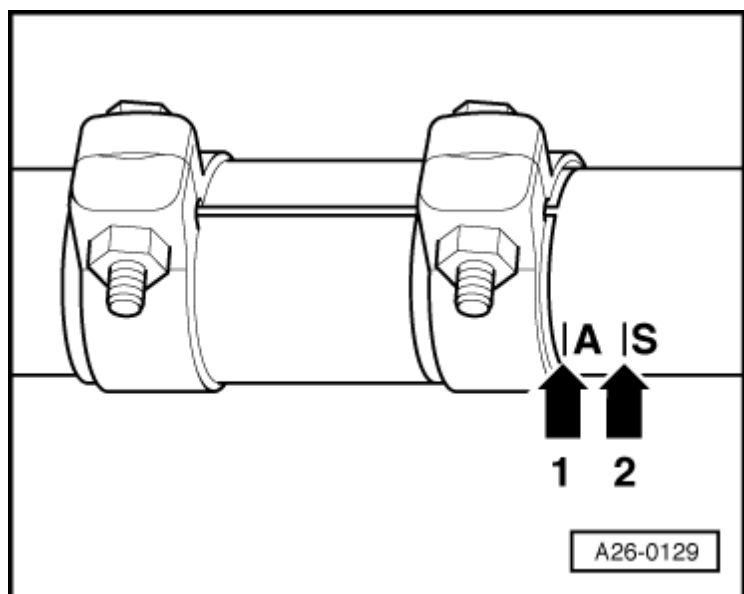

– Fit clamp so that ends of bolts do not protrude beyond bottom of clamp.

1 Bolt connection faces to left.

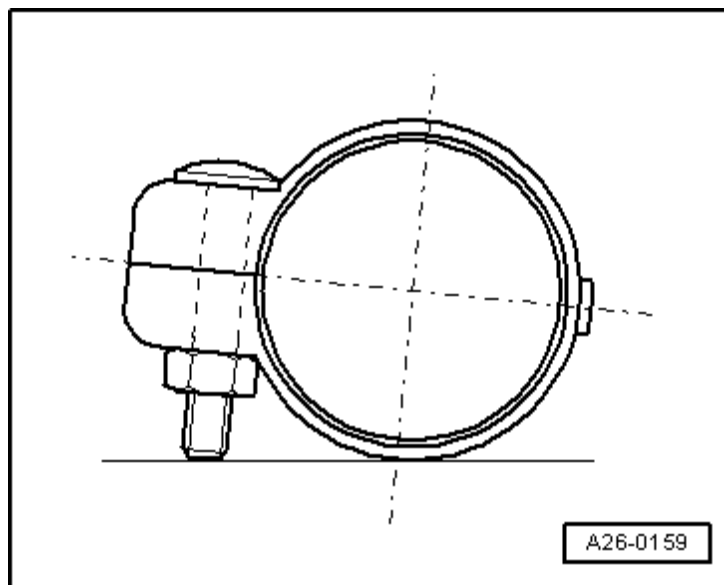

Installation position of rear clamp

1 - $\alpha$ - = 40°.

1 Bolt connection faces front.

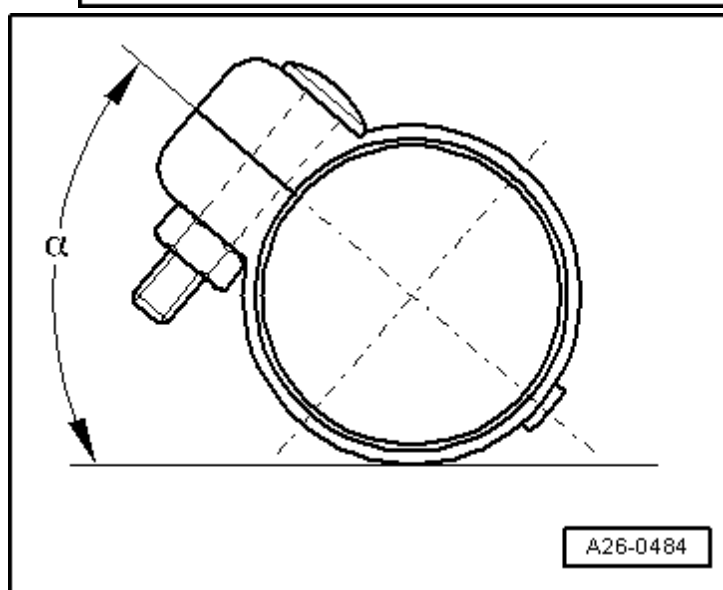

Installation position of mounting

1 Flanged end on base of mounting -  
 arrow- faces in direction of travel.

